

Westwood Village

4700 S 2700 W Taylorsville, UT 84118

Office
Retail
Industrial
Land

RETAIL/RESTAURANT SPACE



CO-TENANTS

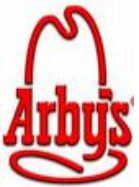

PROPERTY INFORMATION

\$8 - \$14 / NNN

1,200 1,800 3,600 SF Available
Retail / Restaurant / Office Space

Dock High Doors

Great Mid-Valley Location

Easy Access

Ample Parking

Conveniently Located off I-215

Outdoor Lighting

Demographics	1 Mile	3 Mile	5 Mile
Population	16,125	170,726	355,707
Average HH Income	\$68,930	\$62,576	\$62,396
Average Retail Income	\$8,112,714	\$78,123,938	\$162,633,142
Average Daily Traffic - North/South			25,585
Average Daily Traffic - East/ West			37,665



635 W 5300 S Suite 202
Murray, Utah 84123
Office (801) 486-3399
Fax (801) 487-3971
www.arrowutah.com

For more information, contact

Lori Kennedy

Cell (801) 573-9014

lori@arrowutah.com

Elaine Crossley

Cell (801) 891-8371

elaine@arrowutah.com

Westwood Village

4700 S 2700 W Taylorsville, UT 84118

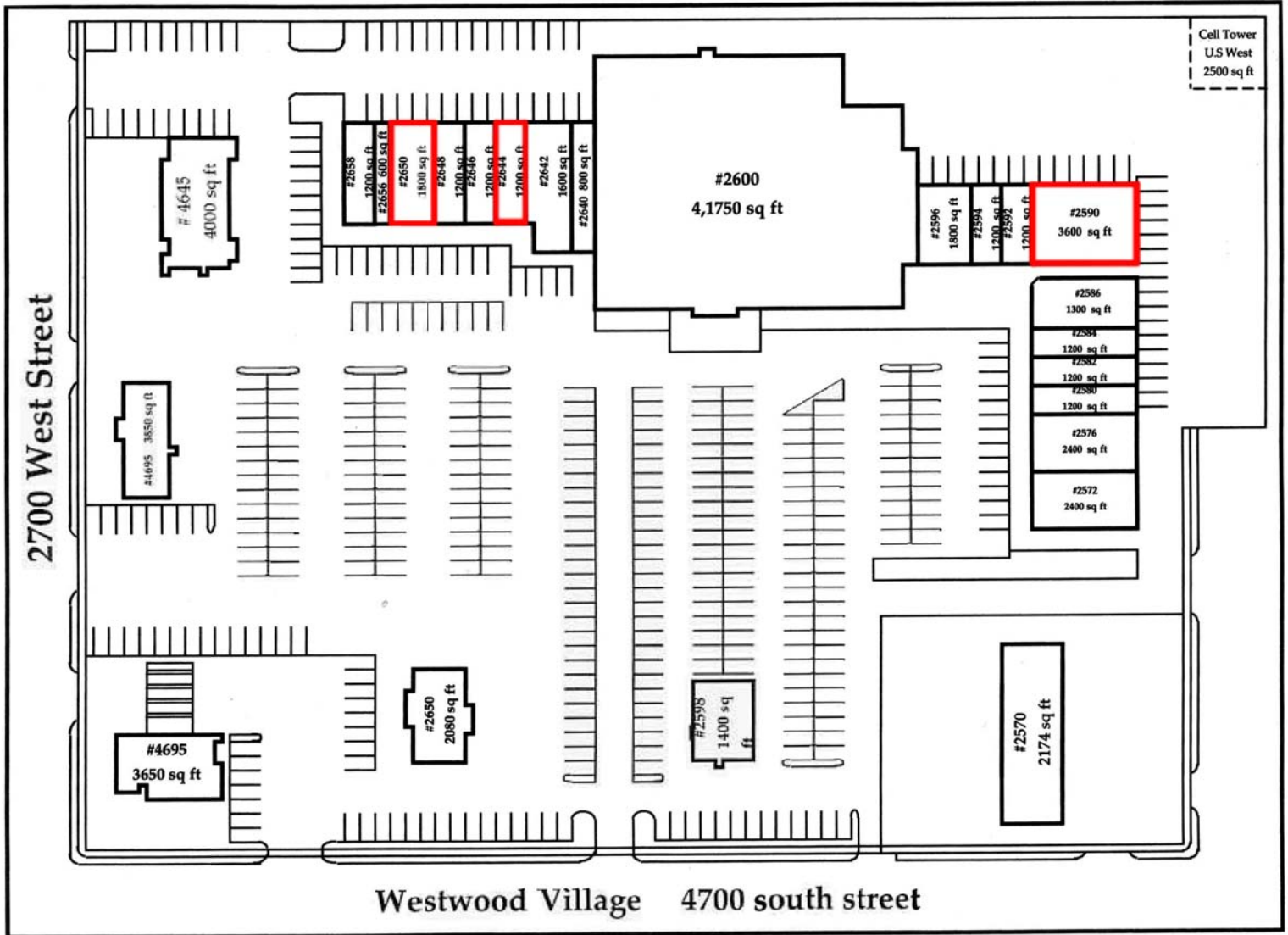

635 W 5300 S Suite 202
Murray, Utah 84123
Office (801) 486-3399
Fax (801) 487-3971
www.arrowutah.com

For more information, contact

Lori Kennedy
Cell (801) 573-9014
lori@arrowutah.com
Elaine Crossley
Cell (801) 891-8371
elaine@arrowutah.com